

# Replacing the Battery Pack of a Unite Bodypack Device

## Service Note

Export Date: 04/17/2026

Exported by: Emilie Mesureur

# Table of Contents

<b>1. Document Information</b> .....	<b>3</b>
<b>2. Safety Instructions</b> .....	<b>4</b>
2.1. Getting Started .....	4
2.2. Safety Notes, Technical Specifications and Spare Parts .....	4
<b>3. Replacing the Battery Pack</b> .....	<b>7</b>
3.1. Exploded drawing .....	7
3.2. Preparation.....	7
3.3. Disassembly .....	8
3.4. Reassembly .....	10

## 1. Document Information

<b>Version</b>	1.06
<b>Creation date</b>	2024/10/18
<b>Last update</b>	2026/04/16
<b>Author(s)</b>	ROH / CLY
<b>Type</b>	Service note
<b>Range of product</b>	Unite
<b>Product</b>	Unite TP (71.98.4010, 71.98.4011, 71.98.4012) Unite RP-T (71.98.4003, 71.98.4004, 71.98.4005) Unite RP (71.98.4000, 71.98.4001, 71.98.4002)
	

## 2. Safety Instructions

### 2.1. Getting Started

**Important:**

Televic recommends that all service procedures are performed by a factory-authorized service center or that products are returned directly to Televic Service Center for repair.

This service manual is a comprehensive guide on how to repair Unite TP, Unite RP-T and Unite RP devices professionally.

A certain level of training in the field of electronics or repairing electronic devices is required to perform the repair in a safe and reliable way.

Please observe the warnings, which are structured as following:

**!** This warning sign is used to indicate hazard potential or special precautionary measures in the red text boxes as well as in the continuous text. Please always take the warning sign seriously and follow the instructions under it carefully.

**T** This text block is highlighted in red and contains important information about the following section, such as general warnings to be observed when performing the following activities, as well as information about the required tools and spare parts.

### 2.2. Safety Notes, Technical Specifications and Spare Parts

Battery safety precautions

The devices are operated with one of the following battery types:

	<ul style="list-style-type: none"> <li>• BAT-3707 → manufacturer: beyerdynamic, article number: 727679, lithium-ion, 3.7 V, 1.88 Ah, 6.96 Wh, blue foil wrapping</li> </ul>
---	---



- UNITE BP → manufacturer: Televic, article number: 71.98.4038, lithium-ion, 3.6 V, 1.20 Ah, 7.92 Wh, black foil wrapping

Only use these specified batteries. Otherwise Televic NV cannot guarantee proper function or safety operation of the device.

#### *Electrical misuse*

- Only charge the battery mounted inside the device with a Unite charger or appropriate USB 2.0/3.0 compliant 5.0V power supply via the USB type-C port of the device.
- Do not charge the battery reversely.
- Do not short circuit any terminals of the battery with metallic objects intentionally.

#### *Environmental misuse*

- Do not leave the battery near the fire or a heated source.
- Do not throw the battery into the fire.
- Do not leave, charge or use the battery in a place where the inside temperature may be over or below the stated values in the device manuals.
- Do not immerse, throw or submerge the battery in water.

#### *Safety instructions*

- Do not pierce the battery with a sharp object such as a needle or a screw driver.
- Do not heat parts of the battery with heated objects such as soldering iron.
- Do not hit the battery with heavy objects such as a hammer.
- Do not step on the battery and throw or drop the battery on a hard floor to avoid mechanical shock.
- Do not disassemble the battery or modify the battery design including its safety circuit.
- Do not use seriously damaged or deformed battery.
- Do not put the battery into a microwave oven, dryer, or high-pressure container.
- Do not use or assemble the battery with other manufacturers' batteries, different types and/or models of batteries such as dry batteries, nickel-metal hydride batteries, or nickel-cadmium batteries.
- Do not reuse an old battery.

#### *Other*

- Do not store the battery in an enclosure together with metallic objects such as keys, necklaces, hairpins, coins, screws, etc.
- A completely new battery may need to be charged and discharged several times before it has reached its full charge capacity.
- Follow further battery instructions stated in the device manuals.

### Warning

- Stop charging the battery if the charging isn't completed within the specified time.
- Stop using the battery if the battery becomes abnormally hot, or if discoloration, deformation, or abnormal conditions are detected during use, charge, or storage.
- Keep away from fire immediately when leakage or foul odors are detected. If liquid leaks onto your body or cloths, wash well with fresh water immediately.
- If liquid leaking from the battery gets into your eyes, don't rub your eyes and wash them with clean water and go see a doctor immediately.
- If the terminals of the battery become dirty, wipe with a dry cloth before using the battery.
- The battery can be used within the temperature ranges stated in the device and charger datasheets. Don't exceed these ranges.

### Disposal

	<ul style="list-style-type: none"> <li>• A discharged battery is more safe to dispose. If it is still possible in a safe way, please discharge the battery in the device before removing it.</li> <li>• At the end of its operating life, this product and battery may not be disposed of along with normal household waste. Please take it to a designated recycling point for electric and electronic appliances. This is indicated by the symbol opposite on the product, the operating instructions or the packaging.</li> <li>• To avoid a short circuit, cover the battery terminal with proper insulating tape before disposal.</li> </ul>
---	---

### Electrostatic precautions

- Observe precautions for handling this static-sensitive device.
- Use an electrostatic protected area!
- Look up EN 61340-5-1 and EN 61340-5-2 standards for further information.

### General remarks

- REFER all servicing to qualified service personnel only!
- OBSERVE all safety regulations when handling electrical power!
- Please be sure to observe the torques of the individual screw connections indicated in the exploded drawings for all repairs. This is the only way to ensure proper functioning and integrity of the devices.
- Televic NV will not be liable if any damage, injury or accident occurs due to negligent, incorrect or inappropriate operation of the product.

The technical specifications can be found in the data sheets or operating instructions of the devices.

These can be found at: <https://conference.televic.digital/knowledgebase/products/unite/>

To order the spare parts listed in the service instructions, please contact your known distributor or the Televic Conference Support.

### 3. Replacing the Battery Pack

#### 3.1. Exploded drawing

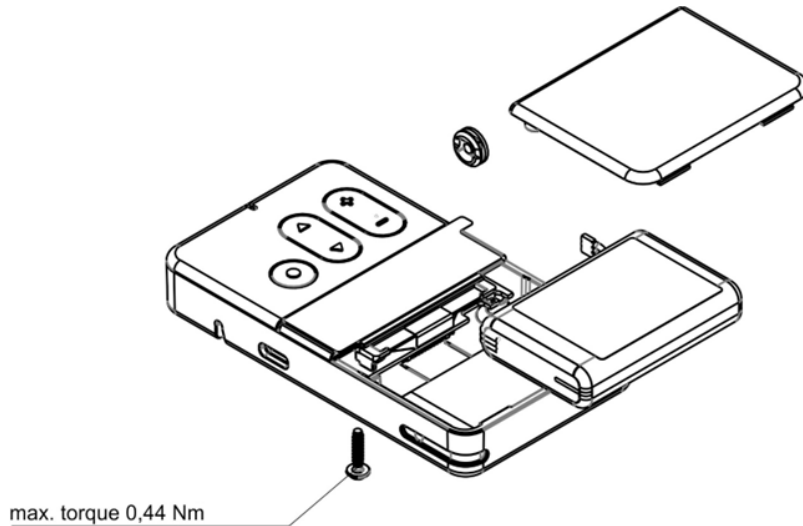

#### 3.2. Preparation

Required tools	T8 Torx screwdriver, flat-tip screwdriver
Required spare parts	71.98.4039 - Unite BP - Li-ion spare battery pack for Unite TP, RP, RP-T (contains 10 batteries)
Required safety equipment	Anti-static wrist band to avoid damaging the electronics due to ESD

### 3.3. Disassembly



1. Place the RP/RP-T/TP device face down on an ESD-protected work surface.

 If the lanyard is still attached to the bodypack device, make sure that it is not in the way. A removal is not necessary.

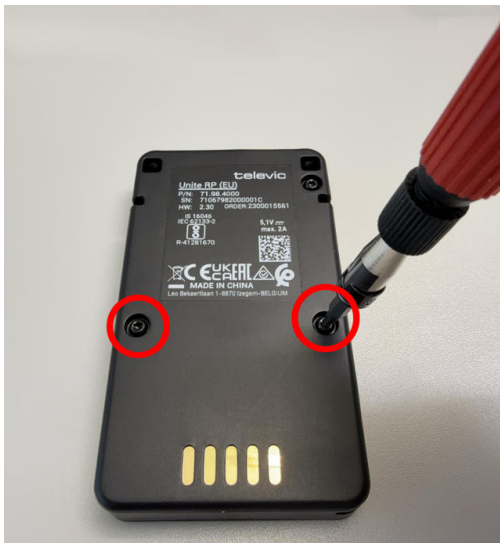

2. Loosen the two Torx T8 screws located in the middle of the rear panel. Then put the screws aside for reassembly.



4. Move the battery pack upwards by levering it with a screwdriver. Use caution and do not use force to avoid damaging the battery pack.



5. After taking the battery pack out of the device, disconnect the cable connector on the circuit board. If possible, pull only the plug, not the cable.

6. Put the used battery aside in a safe place for future disposal.

**!** Follow the safety notes for disposal stated earlier in the document.

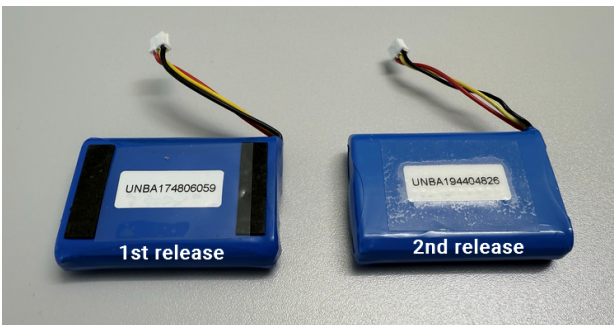

7. Grab the new battery.  
There are two types of Unite RP/RP-T/TP batteries (see pictures and detailed information at the top of this document):

- a. The old blue model from Beyerdynamic
  - i. with foam stripes (1st release)
  - ii. and without (2nd release)
- b. the new black model from Televic

8. From now on, only the black model is available as a spare part. The differences from blue to black model are a higher capacity and improved battery chemistry.



**New battery**

### 3.4. Reassembly

1. Place the opened RP/RP-T/TP on an ESD-protected work surface.

 If the lanyard is still attached to the bodypack device, make sure that it is not in the way. A removal is not necessary.



2. Connect the new battery.  
Be aware that the cable should not get pinched or squeezed. Compare the cable routing with another factory default device.

 The areas on the sides of the battery pack through which the screws pass should never be covered by the cable.

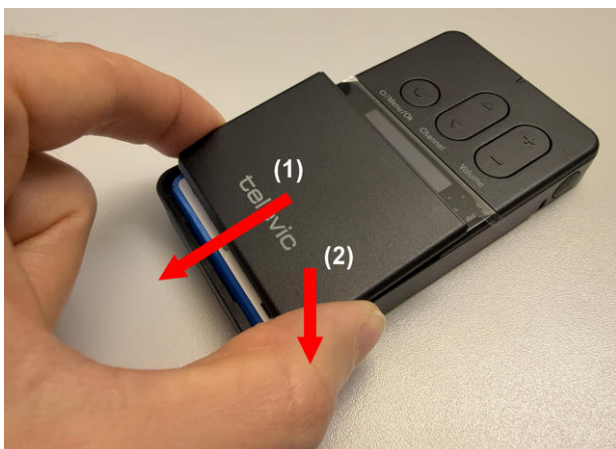

3. Put back the cover of the housing by first pushing it under the two retaining snaps away from the display (1) and then by pushing it down (2).



4. Carefully turn the housing over, and screw the two Torx T8 screws back in place.

⚠ Use a torque of 0.44 Nm maximum to avoid damage to the device.

5. After inserting the new battery pack, switch on the device and check if a charge level is displayed in the battery symbol on the display after a few seconds. If not, please remove and insert the battery again.
6. If you have installed a new black Unite BP battery pack, you need to update to the newest firmware version available to ensure proper capacity estimation. The first firmware version which supports this new battery pack is V0184.
7. Go to the menu "System" -> "Reset" -> "Reset battery".
  - a. For firmware version V0184 or higher: Select the correct profile according to the label of the battery pack.
  - b. Devices below HW 3.01 can support both existing and new battery pack. Please select the correct profile, otherwise the battery estimation will not work correct!
    - i. For the old blue battery pack, please select the profile: BAT-3707 (727.679). When the reset is performed, the following text is shown on the device display: "BAT-3707 (727.679) Battery resetting"
    - ii. For the new black battery pack, please select the profile: UNITE BP (71.98.4038). When the reset is performed, the following text is shown on the device display: "Unite BP (71.98.4038) Battery resetting"
  - c. Devices with HW 3.01 or newer can only support the new battery pack. When the reset is performed, the following text is shown on the device display: "Unite BP (71.98.4038) Battery resetting". Do not use the old blue battery pack in devices with HW 3.01 or newer, because the charging and discharging is not designed for this old battery!
8. Then proceed to charge the device following the steps as described in the [Unite System User Manual](#) under the chapter "Quick Operational Setup > Charging > Charging and Recharging the Transmitters and Receivers Before First Use".

# televic

## HQ Belgium

+32 51 30 30 45

[conference@televic.com](mailto:conference@televic.com)

[www.televic.com/en/conference](http://www.televic.com/en/conference)

## Asia

+86 21 61 48 01 23

[conference@televic.co](mailto:conference@televic.co)

[www.televic-conference.com.cn](http://www.televic-conference.com.cn)

## France

+33 3 74 09 52 76

[conference-france@televic.com](mailto:conference-france@televic.com)

[www.televic-conference.fr](http://www.televic-conference.fr)

## United States

+1 916 920 0901

[conference-us@televic.com](mailto:conference-us@televic.com)

*All information  
copyright Televic  
Conference, 2026.  
Televic reserves the  
right to change this  
document without  
notice.*